

# DENON®

## PMA-800NE

INTEGRATED AMPLIFIER

# Quick Start Guide

Kurzanleitung / Guide de démarrage rapide / Guida di Avvio Rapido /  
Guía de inicio rápido / Snelhandleiding / Snabbstartsguide /  
Краткое руководство пользователя / Skrócona instrukcja obsługi

## Read Me First....

Bitte zuerst lesen... / Lisez-moi en premier... / Nota preliminare... /  
Lea esto primero... / Lees mij eerst... / Läs detta först... /  
Прочитайте в первую очередь... / Przeczytaj to najpierw....

ENGLISH

DEUTSCH

FRANÇAIS

ITALIANO

ESPAÑOL

NEDERLANDS

SVENSKA

РУССКИЙ

POLSKI

# Welcome

Thank you for choosing a Denon amplifier.  
This guide provides step-by-step instructions for setting up your amplifier.





**Please do not return this unit to the store – call for assistance.**

## If you need help... :

If you need additional help in solving problems, contact Denon customer service in your area.  
For details, see the Denon homepage.  
[www.denon.com](http://www.denon.com)

# Before You Begin

## What's In the Box

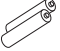
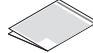
Quick Start Guide		Integrated Amplifier	
CD-ROM (Owner's Manual)		Remote control unit (RC-1223)	
Safety Instructions		R03/AAA batteries	
Cautions on Using Batteries			

## Required for Basic connections

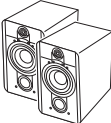
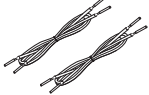
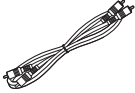
			
CD player	Speaker systems	Speaker cables	Audio cable



- These drawings are for illustrative purposes only and may not represent the actual product(s).

# Setup

There are five steps to the setup process.

- 1** Install batteries in the remote control unit
- 2** Connect the speakers to the amplifier
- 3** Connect the CD player to the amplifier
- 4** Plug the power cord into a power outlet
- 5** Begin CD playback

## **1** Install batteries in the remote control unit

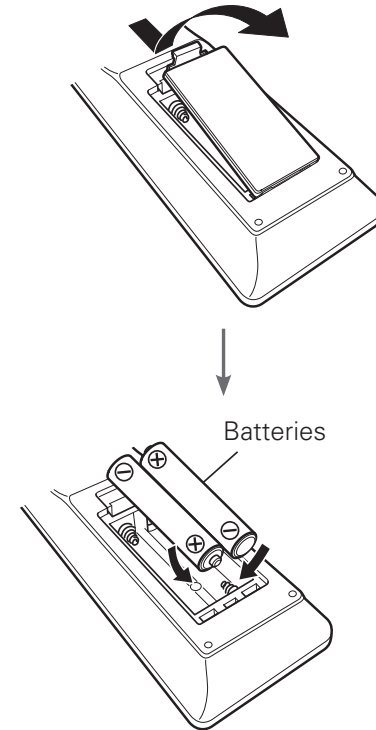

## 2 Connect the speakers to the amplifier

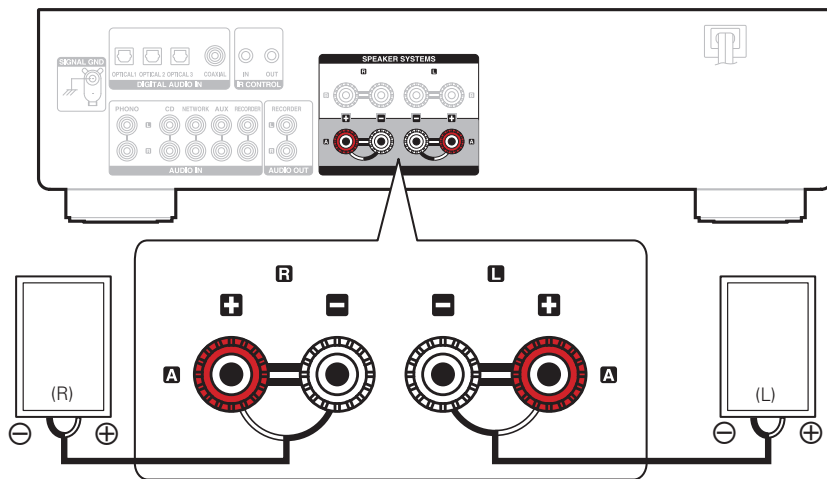

### Connecting the speaker cables

- 1 Peel off about 10 mm of sheathing from the tip of the speaker cable, then either twist the core wire tightly or apply solder to it.
- 2 Turn the speaker terminal counterclockwise to loosen it.
- 3 Insert the speaker cable's core wire to all the way into the speaker terminal.
- 4 Turn the speaker terminal clockwise to tighten it.

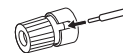

### 3 Connect the CD player to the amplifier

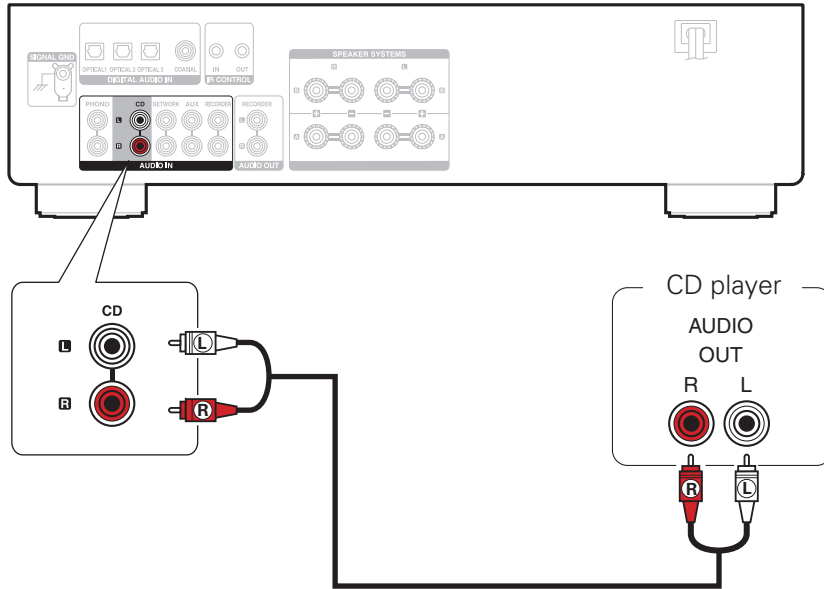

## 4 Plug the power cord into a power outlet

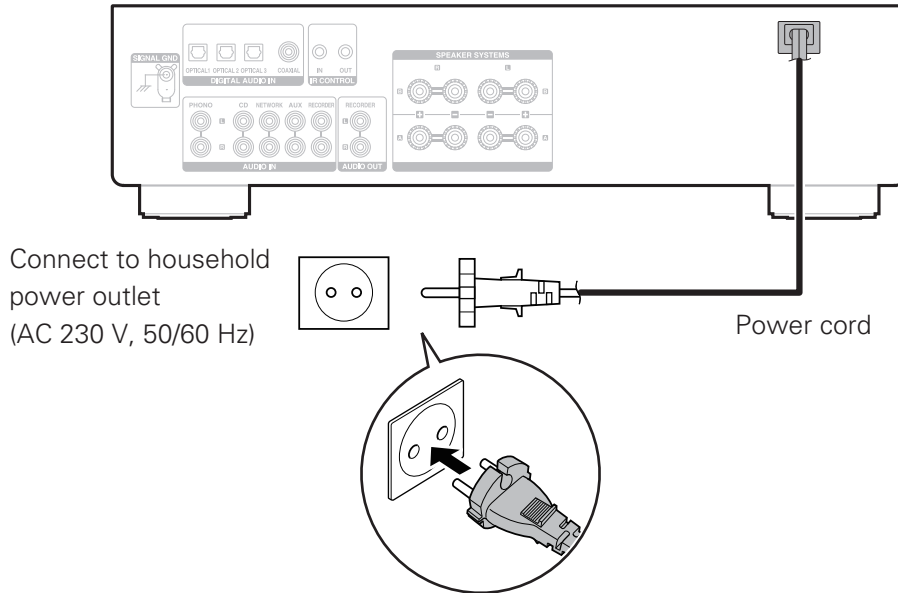

## 5 Begin CD playback

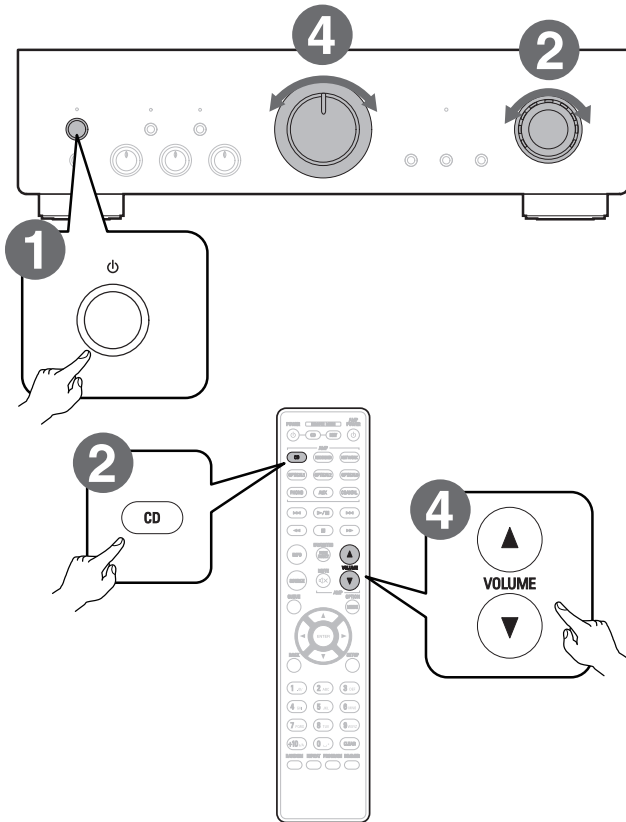

**1 Press the power operation button.**  
Turn VOLUME on the main unit to adjust the volume to the lowest level before turning on the power.

**2 Set the input source to “CD”.**  
The “CD” input indicator lights.

**3 Play the CD player.**

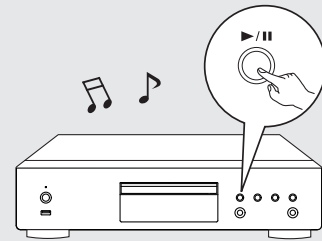

**4 Adjust the volume.**

# Owner's Manual

Please reference to the Owner's Manual for more details about the setup and operation of the amplifier and its features.

## ❑ Online Version

Enter the following URL into your web browser:  
[manuals.denon.com/PMA800NE/EU/EN/](http://manuals.denon.com/PMA800NE/EU/EN/)



Online Manual

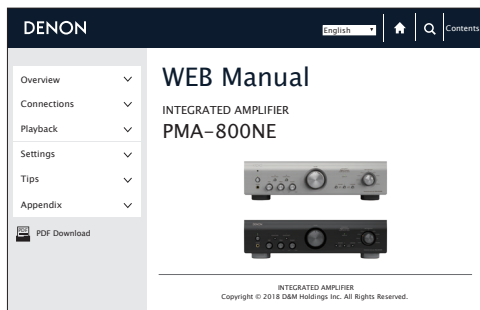

## ❑ Printable Version

Access the print version of the owner's manual from the included CD-ROM or select the "PDF Download" link from the Online Version.

1

**Insert the disc into your PC.**

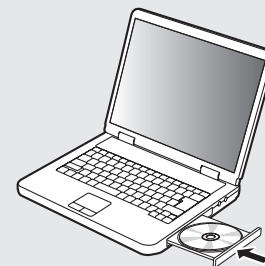

2

**Follow the screen or double click on the PDF file.**



**DENON®**

[www.denon.com](http://www.denon.com)

Printed in Vietnam 5411 11663 00AD  
Copyright © 2018 D&M Holdings Inc. All Rights Reserved.